

CL-H COPPER TUBE TERMINALS CL-H铜管端子

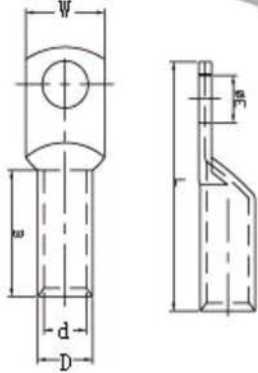

PART NO 2015-2018	ITEM NO	DIMENSIONS					
		φE	ΦD	Φd	W	B	L
LY0005-0001	CL14-H-6	6.4	8.8	5.8	18.3	28.5	50.0
LY0005-0002	CL22-H-8	8.4	11.3	7.7	18.3	28.5	52.0
LY0005-0003	CL38-H-10	10.5	12.4	9.8	18.3	34.0	64.0
LY0005-0004	CL38-H-12	13.0	12.4	9.8	18.3	34.0	64.0
LY0005-0005	CL60-H-10	10.5	14.0	11.0	20.5	36.0	70.0
LY0005-0006	CL60-H-12	13.0	14.0	11.0	20.5	36.0	70.0
LY0005-0007	CL70-H-10	10.5	15.0	12.0	21.4	38.0	72.0
LY0005-0008	CL70-H-12	13.0	15.0	12.0	21.4	38.0	72.0
LY0005-0009	CL80-H-12	13.0	16.0	13.0	23.2	38.0	75.0
LY0005-0010	CL100-H-12	13.0	18.0	14.0	26.0	40.0	75.0
LY0005-0011	CL125-H-12	13.0	20.0	16.0	28.0	40.0	85.0
LY0005-0012	CL150-H-12	13.0	22.0	17.0	31.5	46.0	94.0
LY0005-0013	CL180-H-12	13.0	23.0	18.2	33.0	46.0	98.0
LY0005-0014	CL200-H-12	13.0	26.0	20.0	37.0	48.0	104.0
LY0005-0015	CL250-H-12	13.0	28.0	22.0	41.0	48.0	114.0
LY0005-0016	CL325-H-12	13.0	32.0	25.0	46.0	50.0	118.0
LY0005-0017	CL400-H-12	13.0	37.0	30.0	54.0	60.0	130.0
LY0005-0018	CL500-H-12	13.0	40.0	31.0	57.5	60.0	150.0
LY0005-0019	B-CL14-H-6	6.4	8.3	5.8	18.3	28.5	50.0
LY0005-0020	B-CL22-H-8	8.4	10.7	7.7	18.3	28.5	52.0
LY0005-0021	B-CL38-H-10	10.5	11.9	9.8	17.2	34.0	64.0
LY0005-0022	B-CL38-H-12	13.0	11.9	9.8	17.2	34.0	64.0
LY0005-0023	B-CL60-H-10	10.5	13.5	11.0	20.0	36.0	70.0
LY0005-0024	B-CL60-H-12	13.0	13.5	11.0	20.0	36.0	70.0
LY0005-0025	B-CL70-H-10	10.5	14.5	12.0	21.4	38.0	72.0
LY0005-0026	B-CL70-H-12	13.0	14.5	12.0	21.4	38.0	72.0
LY0005-0027	B-CL80-H-12	13.0	15.5	13.0	23.2	38.0	75.0
LY0005-0028	B-CL100-H-12	13.0	17.3	14.0	25.5	40.0	75.0
LY0005-0029	B-CL125-H-12	13.0	19.3	16.0	28.0	40.0	85.0
LY0005-0030	B-CL150-H-12	13.0	21.1	17.0	30.5	46.0	94.0
LY0005-0031	B-CL180-H-12	13.0	22.1	18.2	32.5	46.0	98.0
LY0005-0032	B-CL200-H-12	13.0	24.9	20.0	36.0	48.0	104.0
LY0005-0033	B-CL250-H-12	13.0	26.9	22.0	39.5	48.0	114.0
LY0005-0034	B-CL325-H-12	13.0	30.7	25.0	45.0	50.0	118.0
LY0005-0035	B-CL400-H-12	13.0	35.7	30.0	54.0	60.0	130.0
LY0005-0036	B-CL500-H-12	13.0	38.4	31.0	56.0	60.0	150.0